

# 5.20 Klemmkupplung

## Produktinformationen

### Material

- PVC-U = Polyvinylchlorid ohne Weichmacher

### Herstellung

- Spritzguss

## Zubehör



4.18  
Klemmring

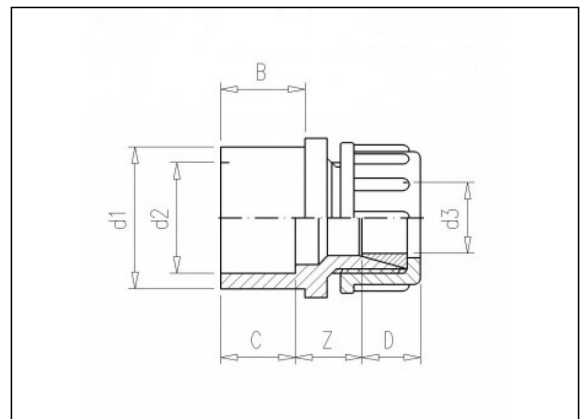

## Verfügbare Artikel

ART.CODE	d1	d2	d3	Z	B	C	D	Type	Verp
5.20.005	50	40	32	23	27	32	15	Soft*	200
5.20.010	50	40	32	23	27	32	15	Hard*	200
5.20.015	-	50	40	26	33	32	17	Soft*	100
5.20.020	75	63	50	43	44	38	13	Soft*	50
5.20.025	90	75	63	51	51	44	13	Soft*	25
5.20.030	110	90	75	55	61	51	21	Soft*	18
5.20.035	-	110	90	48	60	61	21	Soft*	10

### Van de Lande BV

Lissenveld 1 \ 4941 VK Raamsdonksveer \ The Netherlands \ t +31 (0)162 51 60 00 \ f +31 (0)162 52 14 17 \ sales@vandelande.com  
 Traderegister Tilburg: 18070844 \ IBAN: NL13 RABO 0143 0035 26 \ BIC: RABONL2U \ VAT: NL 8123.91.755.B01