

# PVC-C Elbow 45°

## Product information

### Material

- PVC-C = Polyvinylchloride post chlorinated

### Manufacture

- Injection moulded

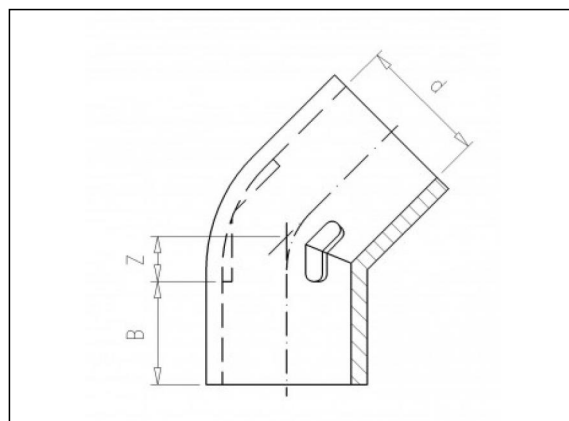

## Available items

| ART.CODE   | d   | Z    | B  | PN | Verp |
|------------|-----|------|----|----|------|
| 7006702001 | 20  | 5    | 16 | 16 | 130  |
| 7006702501 | 25  | 6    | 19 | 16 | 150  |
| 7006703201 | 32  | 8    | 22 | 16 | 260  |
| 7006704001 | 40  | 10   | 26 | 16 | 150  |
| 7006705001 | 50  | 12   | 31 | 16 | 80   |
| 7006706301 | 63  | 14.5 | 38 | 16 | 60   |
| 7006707501 | 75  | 18   | 44 | 16 | 35   |
| 7006709001 | 90  | 19   | 51 | 16 | 24   |
| 7006711001 | 110 | 26   | 61 | 16 | 12   |

### Van de Lande BV

Lissenveld 1 \ 4941 VK Raamsdonksveer \ The Netherlands \ t +31 (0)162 51 60 00 \ f +31 (0)162 52 14 17 \ sales@vandelande.com  
Traderegister Tilburg: 18070844 \ IBAN: NL13 RABO 0143 0035 26 \ BIC: RABONL2U \ VAT: NL 8123.91.755.B01

ART.CODE    d        Z        B        PN        Verp

---

**Van de Lande BV**

Lissenveld 1 \ 4941 VK Raamsdonksveer \ The Netherlands \ t +31 (0)162 51 60 00 \ f +31 (0)162 52 14 17 \ sales@vandelande.com  
Traderegister Tilburg: 18070844 \ IBAN: NL13 RABO 0143 0035 26 \ BIC: RABONL2U \ VAT: NL 8123.91.755.B01

All our transactions are subject to the Van de Lande General Terms of Sale. A copy of these can be provided immediately upon your request.