

2.31 Elbow 45°

Product information

Material

- PVC-U = Unplasticised Polyvinylchloride

Manufacture

- Injection moulded

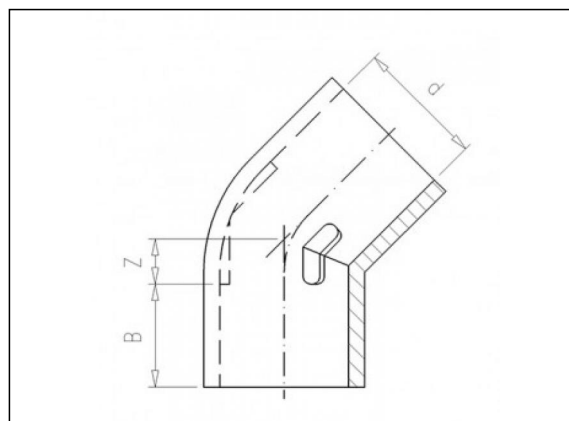

Available items

ART.CODE	d	Z	B	PN	Verp
2.30.075	2 1/2	18	44	16	35
2.30.140	5	30	76	16	6
2.31.020	1/2	5	17	16	125
2.31.025	3/4	6.5	20	16	150
2.31.032	1	8	23	16	250
2.31.040	1 1/4	10.5	28	16	150
2.31.050	1 1/2	12.5	31	16	100
2.31.063	2	16	37	16	65
2.31.090	3	19.5	51	16	24

Van de Lande BV

Lissenveld 1 \ 4941 VK Raamsdonksveer \ The Netherlands \ t +31 (0)162 51 60 00 \ f +31 (0)162 52 14 17 \ sales@vandelande.com
Traderegister Tilburg: 18070844 \ IBAN: NL13 RABO 0143 0035 26 \ BIC: RABONL2U \ VAT: NL 8123.91.755.B01

ART.CODE	d	Z	B	PN	Verp
2.31.110	4	24	63	16	12
2.31.160	6	42	91	16	2

Van de Lande BV

Lissenveld 1 \ 4941 VK Raamsdonksveer \ The Netherlands \ t +31 (0)162 51 60 00 \ f +31 (0)162 52 14 17 \ sales@vandelande.com
Traderegister Tilburg: 18070844 \ IBAN: NL13 RABO 0143 0035 26 \ BIC: RABONL2U \ VAT: NL 8123.91.755.B01

All our transactions are subject to the Van de Lande General Terms of Sale. A copy of these can be provided immediately upon your request.