

# 3.20 Adaptor nipple

## Product information

### Characteristics

- Straight BSP male thread

### Material

- PVC-U = Unplasticised Polyvinylchloride

### Manufacture

- Injection moulded

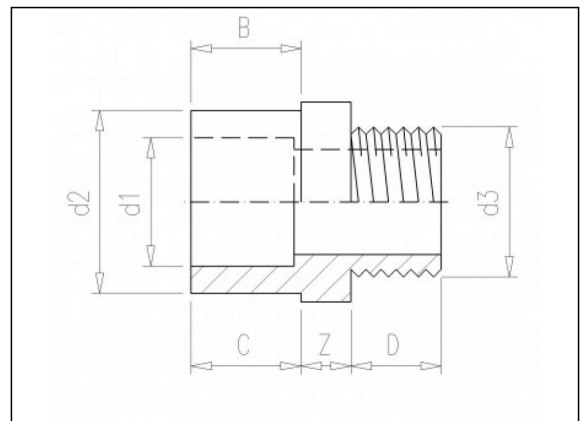

## Available items

ART.CODE	d1	d2	d3	Z	B	C	D	PN	Verp
3.20.030	25	32	1/2" (M)	6	22	19	18	10	500
3.20.045	25	32	3/4" (M)	5	22	19	17	10	500
3.20.050	25	32	1" (M)	6	22	19	17	10	500
3.20.055	32	40	1" (M)	5	23	22	17	10	500
3.20.060	32	40	1 1/4" (M)	4	23	22	18	10	600

### Van de Lande BV

Lissenveld 1 \ 4941 VK Raamsdonksveer \ The Netherlands \ t +31 (0)162 51 60 00 \ f +31 (0)162 52 14 17 \ sales@vandelande.com  
 Traderegister Tilburg: 18070844 \ IBAN: NL13 RABO 0143 0035 26 \ BIC: RABONL2U \ VAT: NL 8123.91.755.B01

ART.CODE	d1	d2	d3	Z	B	C	D	PN	Verp
3.20.065	40	50	1 1/4" (M)	11	28	27	23	10	300
3.20.070	40	50	1 1/2" (M)	12	28	27	23	10	275
3.20.075	50	-	1 1/2" (M)	12	-	31	23	10	200
3.20.080	50	-	2" (M)	12	-	31	27	10	150
3.20.090	63	-	2" (M)	8	-	38	27	10	120

**Van de Lande BV**

Lissenveld 1 \ 4941 VK Raamsdonksveer \ The Netherlands \ t +31 (0)162 51 60 00 \ f +31 (0)162 52 14 17 \ sales@vandelande.com  
Traderegister Tilburg: 18070844 \ IBAN: NL13 RABO 0143 0035 26 \ BIC: RABONL2U \ VAT: NL 8123.91.755.B01

[www.vandelande.com](http://www.vandelande.com)

All our transactions are subject to the Van de Lande General Terms of Sale. A copy of these can be provided immediately upon your request.