

# PVC-C Embout fileté

## Informations sur le produit

### Caractéristiques

- Filetage mâle BSP

### Matière

- PVC-C = Polychlorure de vinyle surchloré

### Fabrication

- Moulé par injection

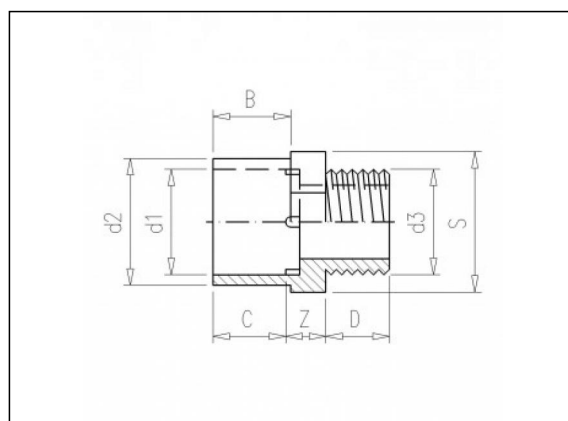

## Articles disponibles

ART.CODE	d1	d2	d3	Z	B	C	D	S	PN	Verp
7015202021	20		1/2" (M)	5	14	16	16	32	16	250
7015202501	25	32	1" (M)	11	22	19	21	36	16	300
7015202511	25	32	3/4" (M)	11	22	19	17	36	16	300
7015203201	32	40	1 1/4" (M)	14	26	22	23	46	16	250
7015203211	32	40	1" (M)	14	26	22	21	46	16	300

### Van de Lande BV

Lissenveld 1 \ 4941 VK Raamsdonksveer \ The Netherlands \ t +31 (0)162 51 60 00 \ f +31 (0)162 52 14 17 \ sales@vandelande.com  
 Traderegister Tilburg: 18070844 \ IBAN: NL13 RABO 0143 0035 26 \ BIC: RABONL2U \ VAT: NL 8123.91.755.B01

ART.CODE	d1	d2	d3	Z	B	C	D	S	PN	Verp
7015204001	40	50	1 1/2" (M)	15.5	31	26.5	23	55	16	160
7015204011	40	50	1 1/4" (M)	15.5	31	26.5	23	55	16	160
7015205011	50	63	2" (M)	18	38	31.5	27	65	16	110
7015205021	50	63	1 1/2" (M)	18	38	31.5	23	65	16	110
7015206321	63	75	2" (M)	1	44	38	27	80	16	80
7015702531	20	25	1/2" (M)	12	19	16	16	36	16	100

**Van de Lande BV**

Lissenveld 1 \ 4941 VK Raamsdonksveer \ The Netherlands \ t +31 (0)162 51 60 00 \ f +31 (0)162 52 14 17 \ sales@vandelande.com  
Traderegister Tilburg: 18070844 \ IBAN: NL13 RABO 0143 0035 26 \ BIC: RABONL2U \ VAT: NL 8123.91.755.B01

All our transactions are subject to the Van de Lande General Terms of Sale. A copy of these can be provided immediately upon your request.