

8.20 Ecrou de raccord pour raccord union

Informations sur le produit

Caractéristiques

- Filetage femelle BSP

Matière

- PVC-U = Polychlorure de vinyle rigide

Fabrication

- Moulé par injection

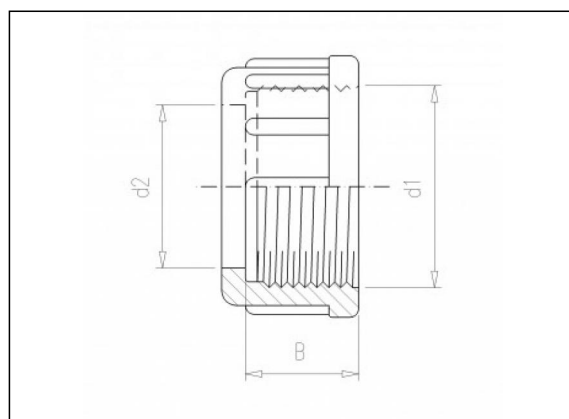

Articles disponibles

| ART.CODE | Dia | d1 | d2 | B | Verp |
|----------|-----|-----------|----|----|------|
| 8.20.016 | 16 | 3/4 (F) | 22 | 16 | 100 |
| 8.20.020 | 20 | 1 (F) | 28 | 16 | 100 |
| 8.20.025 | 25 | 1 1/4 (F) | 36 | 18 | 50 |
| 8.20.032 | 32 | 1 1/2 (F) | 41 | 19 | 50 |
| 8.20.040 | 40 | 2 (F) | 53 | 21 | 25 |

Van de Lande BV

Lissenveld 1 \ 4941 VK Raamsdonksveer \ The Netherlands \ t +31 (0)162 51 60 00 \ f +31 (0)162 52 14 17 \ sales@vandelande.com
Traderegister Tilburg: 18070844 \ IBAN: NL13 RABO 0143 0035 26 \ BIC: RABONL2U \ VAT: NL 8123.91.755.B01

| ART.CODE | Dia | d1 | d2 | B | Verp |
|----------|-----|--------------|----|----|------|
| 8.20.050 | 50 | 2 1/4 (F) | 58 | 24 | 25 |
| 8.20.063 | 63 | 2 3/4 (F) | 74 | 27 | 25 |

Van de Lande BV

Lissenveld 1 \ 4941 VK Raamsdonksveer \ The Netherlands \ t +31 (0)162 51 60 00 \ f +31 (0)162 52 14 17 \ sales@vandelande.com
Traderegister Tilburg: 18070844 \ IBAN: NL13 RABO 0143 0035 26 \ BIC: RABONL2U \ VAT: NL 8123.91.755.B01

All our transactions are subject to the Van de Lande General Terms of Sale. A copy of these can be provided immediately upon your request.