

PVC-C Draadeind

Productinformatie

Eigenschappen

- Buitengasdraad

Materiaal

- PVC-C = Polyvinylchloride post chlorinated

Vervaardiging

- Spuitgiet

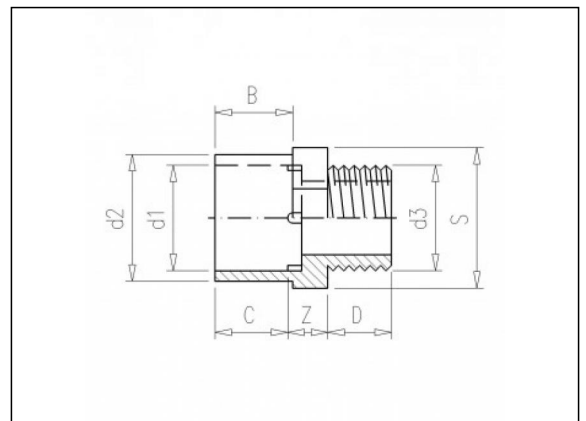

Beschikbare artikelen

| ART.CODE | d1 | d2 | d3 | Z | B | C | D | S | PN | Verp |
|------------|----|----|------------------|----|----|----|----|----|----|------|
| 7015202021 | 20 | | 1/2" (M) | 5 | 14 | 16 | 16 | 32 | 16 | 250 |
| 7015202501 | 25 | 32 | 1" (M) | 11 | 22 | 19 | 21 | 36 | 16 | 300 |
| 7015202511 | 25 | 32 | 3/4" (M) | 11 | 22 | 19 | 17 | 36 | 16 | 300 |
| 7015203201 | 32 | 40 | 1 1/4" (M) | 14 | 26 | 22 | 23 | 46 | 16 | 250 |
| 7015203211 | 32 | 40 | 1" (M) | 14 | 26 | 22 | 21 | 46 | 16 | 300 |

Van de Lande BV

Lissenveld 1 \ 4941 VK Raamsdonksveer \ The Netherlands \ t +31 (0)162 51 60 00 \ f +31 (0)162 52 14 17 \ sales@vandelande.com
 Traderegister Tilburg: 18070844 \ IBAN: NL13 RABO 0143 0035 26 \ BIC: RABONL2U \ VAT: NL 8123.91.755.B01

| ART.CODE | d1 | d2 | d3 | Z | B | C | D | S | PN | Verp |
|------------|----|----|------------------|------|----|------|----|----|----|------|
| 7015204001 | 40 | 50 | 1 1/2" (M) | 15.5 | 31 | 26.5 | 23 | 55 | 16 | 160 |
| 7015204011 | 40 | 50 | 1 1/4" (M) | 15.5 | 31 | 26.5 | 23 | 55 | 16 | 160 |
| 7015205011 | 50 | 63 | 2" (M) | 18 | 38 | 31.5 | 27 | 65 | 16 | 110 |
| 7015205021 | 50 | 63 | 1 1/2" (M) | 18 | 38 | 31.5 | 23 | 65 | 16 | 110 |
| 7015206321 | 63 | 75 | 2" (M) | 1 | 44 | 38 | 27 | 80 | 16 | 80 |
| 7015702531 | 20 | 25 | 1/2" (M) | 12 | 19 | 16 | 16 | 36 | 16 | 100 |

Van de Lande BV

Lissenveld 1 \ 4941 VK Raamsdonksveer \ The Netherlands \ t +31 (0)162 51 60 00 \ f +31 (0)162 52 14 17 \ sales@vandelande.com
Traderegister Tilburg: 18070844 \ IBAN: NL13 RABO 0143 0035 26 \ BIC: RABONL2U \ VAT: NL 8123.91.755.B01

All our transactions are subject to the Van de Lande General Terms of Sale. A copy of these can be provided immediately upon your request.